

# Soils Map

Boundary Lines Are Approximate

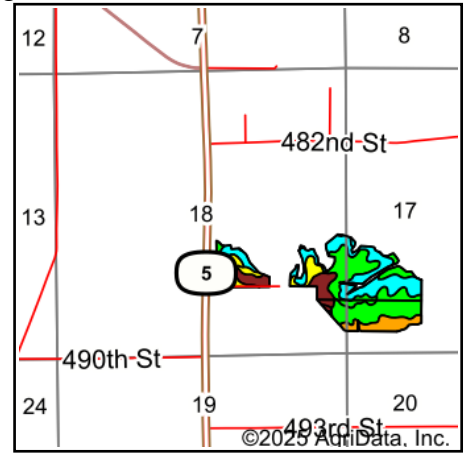
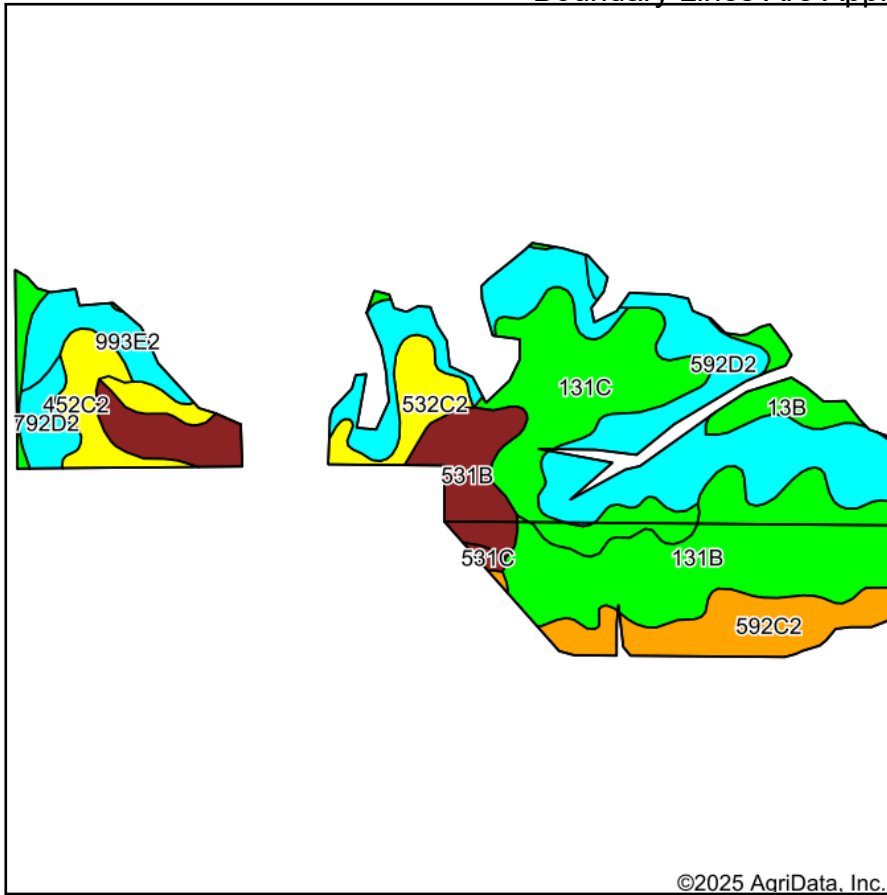

State: **Iowa**  
 County: **Appanoose**  
 Location: **18-69N-17W**  
 Township: **Vermillion**  
 Acres: **75.41**  
 Date: **2/5/2025**

**Hawkeye Farm Mgmt & Real Estate**



22 N Main, Albion IA Phone: 641-932-7796  
 Email: [hawkeye@uciowa.com](mailto:hawkeye@uciowa.com)  
 On the web: [www.uciowa.com](http://www.uciowa.com)  
[www.iowawhitehallfarms.com](http://www.iowawhitehallfarms.com)

Maps Provided By:



Area Symbol: IA007, Soil Area Version: 31

Code	Soil Description	Acres	Percent of field	CSR2 Legend	Non-Irr Class *c	CSR2**	CSR	*n NCCPI Corn	*n NCCPI Soybeans
131B	Pershing silt loam, 2 to 5 percent slopes	15.41	20.6%		IIle	70	67	74	59
592D2	Mystic silt loam, 9 to 14 percent slopes, moderately eroded	13.53	17.9%		IVe	10	5	68	49
131C	Pershing silt loam, 5 to 9 percent slopes	11.95	15.8%		IIle	65	50	72	58
993E2	Armstrong-Gara loams, 14 to 18 percent slopes, moderately eroded complex	8.68	11.5%		VIle	17	10	61	42
531B	Kniffin silt loam, 2 to 5 percent slopes	7.18	9.5%		IIle	55	58	64	66
592C2	Mystic silt loam, 5 to 9 percent slopes, moderately eroded	6.35	8.4%		IIle	31	21	71	52
532C2	Rathbun silty clay loam, 5 to 9 percent slopes, moderately eroded	3.86	5.1%		IIle	44	28	72	51
13B	Olmitz-Vesser-Colo complex, 2 to 5 percent slopes	3.45	4.6%		IIw	79	68	81	80
452C2	Lineville silt loam, 5 to 9 percent slopes, moderately eroded	2.90	3.8%		IIle	46	30	71	52
792D2	Armstrong loam, 9 to 14 percent slopes, moderately eroded	1.83	2.4%		IVe	9	11	62	43
531C	Kniffin silt loam, 5 to 9 percent slopes	0.27	0.4%		IIle	52	36	62	64
Weighted Average					3.50	44.2	37	*n 69.7	*n 55.1

\*\*IA has updated the CSR values for each county to CSR2.

\*n: The aggregation method is "Weighted Average using all components"

\*c: Using Capabilities Class Dominant Condition Aggregation Method