

Soils Map

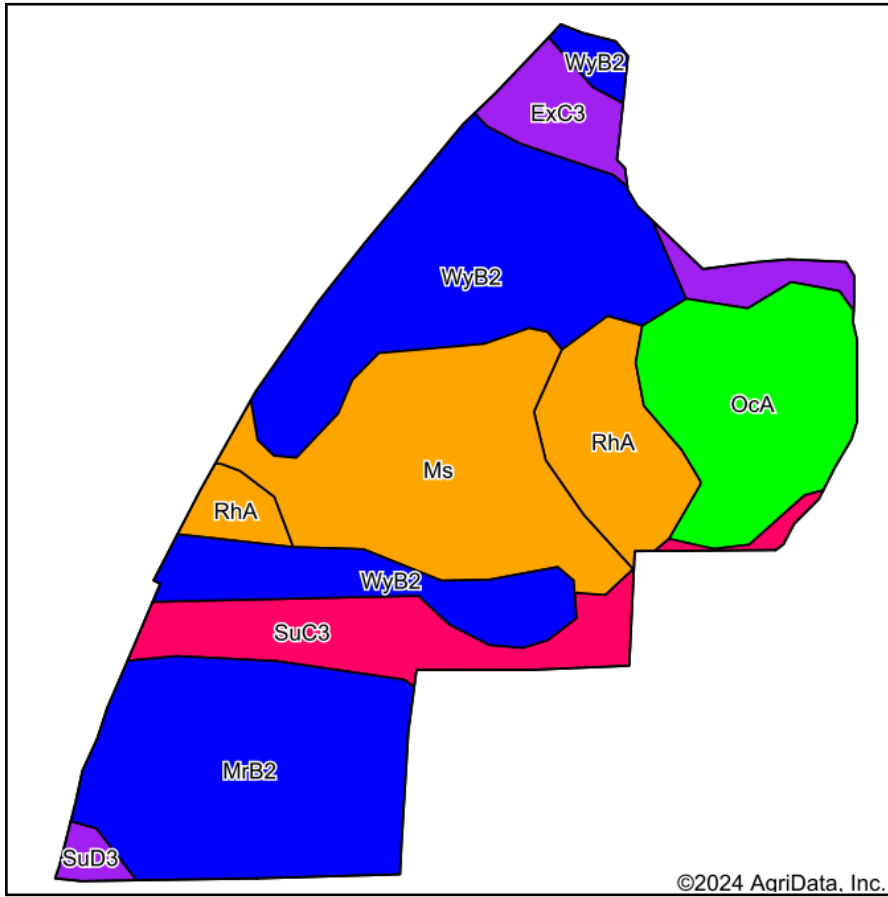

Soils data provided by USDA and NRCS.

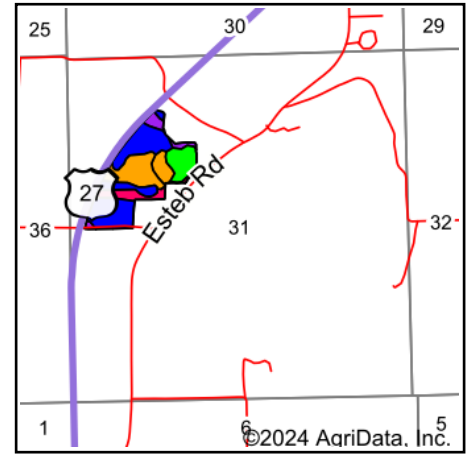

State: **Indiana**
 County: **Wayne**
 Location: **31-13N-1W**
 Township: **Boston**
 Acres: **36.47**
 Date: **11/4/2024**



Maps Provided By:



Area Symbol: IN177, Soil Area Version: 25

Code	Soil Description	Acres	Percent of field	Non-Irr Class Legend	Non-Irr Class *c	Corn Bu	Grass legume hay Tons	Pasture AUM	Soybeans Bu	Winter wheat Bu	*n NCCPI Soybeans
WyB2	Wynn silt loam, 2 to 6 percent slopes, eroded	9.65	26.5%		Ile	99	3	6	34	40	34
MrB2	Miami silt loam, gravelly substratum, 2 to 6 percent slopes, eroded	7.07	19.4%		Ile	157	5	10	55	69	59
Ms	Millsdale silty clay loam, 0 to 2 percent slopes	6.47	17.7%		IIIw	129	4	9	35	52	51
OcA	Ockley silt loam, 0 to 2 percent slopes	4.59	12.6%		I	106	4	7	38	43	71
SuC3	Strawn clay loam, 6 to 12 percent slopes, severely eroded	3.30	9.0%		IVe	121	4	8	43	54	36
RhA	Randolph silt loam, 0 to 2 percent slopes	3.16	8.7%		IIIw	111	4	8	36	50	65
ExC3	Eldean clay loam, 6 to 18 percent slopes, severely eroded	1.91	5.2%		Vle	73	3	5	25	37	38
SuD3	Strawn clay loam, 12 to 18 percent slopes, severely eroded	0.32	0.9%		Vle	106	4	7	38	53	32
Weighted Average					2.56	118.2	3.9	7.7	39.3	50.2	*n 49.6

*n: The aggregation method is "Weighted Average using all components"

*c: Using Capabilities Class Dominant Condition Aggregation Method

Soils data provided by USDA and NRCS.