

# NOTES

1. NO TITLE SEARCH, OF THE SURVEY SITE, WAS PROVIDED TO CUMBERLAND PARTNERS, LLC. PRIOR TO THE COMPLETION OF THIS SURVEY MAP. THEREFORE, THIS MAP IS SUBJECT TO ANY CONFLICTING STATEMENT OF FACTS THAT MAY ARISE FROM A TITLE SEARCH OF THE SURVEYED PREMISES.
2. THIS PROPERTY IS SUBJECT TO ANY AND ALL EASEMENTS WRITTEN OR UNWRITTEN.
3. ALL RECORDS INDICATED HEREON ARE REFERENCED TO THE OFFICES OF THE CIRCUIT COURT CLERK AND COMMISSIONER OF THE REVENUE IN AND FOR THE COUNTY OF LEE.
4. PROPERTY LINES COMMON WITH CUPP, DONNELLY AND SZUCS WAS VERIFIED WITH DONNELLY AND CUPP AT THE TIME OF PRIOR SURVEY.
5. SELECT PROPERTY LINES WERE MARKED WITH LINE RODS DURING THE TIME OF PRIOR SURVEY.

## BEARINGS AND DISTANCES FOR SELECT LINES

LINE	BEARING	DISTANCE
L14	N 18°00'57" W	177.46'
L15	N 19°14'49" W	50.00'
L16	N 19°14'49" W	36.07'
L17	N 22°04'15" W	59.85'
L18	N 20°11'05" W	69.91'
L19	S 70°45'11" E	50.00'
L20	S 19°14'49" E	50.00'
L21	N 70°45'11" E	11.86'
L22	N 75°18'30" E	76.49'
L23	N 30°20'52" W	163.17'
L24	N 21°58'45" W	85.34'
L25	N 18°47'15" W	127.71'
L26	N 28°17'39" W	148.43'
L27	S 28°17'39" E	10.38'

## BEARINGS AND DISTANCES FOR SELECT LINES

LINE	BEARING	DISTANCE
L1	N 75°01'20" E	13.77'
L2	N 74°37'45" E	133.18'
L3	S 06°43'52" W	122.05'
L4	N 68°46'45" W	197.00'
L5	N 34°22'02" W	76.63'
L6	N 84°36'55" W	26.72'
L7	N 15°41'57" W	56.33'
L8	S 67°48'21" E	120.87'
L9	S 06°43'52" W	146.00'
L10	S 08°15'44" E	126.13'
L11	S 21°37'44" E	201.40'
L12	S 25°50'33" E	126.74'
L13	S 26°09'01" E	192.68'



I HEREBY CERTIFY THAT THIS PLAT DEPICTS A CURRENT FIELD SURVEY, MADE BY MYSELF, OR OTHERS UNDER MY DIRECTION.

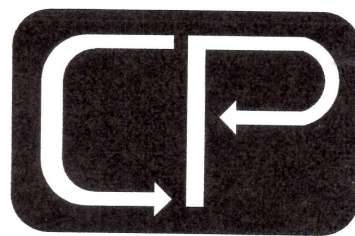
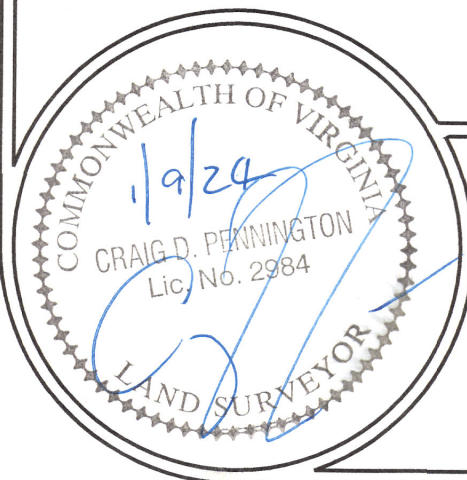

**CUMBERLAND PARTNERS, LLC**  
SURVEYING/MAPPING

P.O. Box 456, JONESVILLE, VIRGINIA 24263 • PHONE/FAX (276) 346-3025