

698 Acres
Trinity Timber L.P.
541-168 OR



1"=150'

J. Ortega Survey A-35
G. Badillo Survey A-4

Point of Beginning
3" Pipe with Brass Disk
marked MK 281 Found

1085.12'

OT Pipe Found

768.67 Acres
Trinity Timber L.P.
541-168 OR

768.67 Acres
Trinity Timber L.P.
541-168 OR

49.192 ACRES
2142809.9 SQ. FT.
49.20 Acres
Carl Wilson
499-520 OR

The subject property is located in Walker County and is not located in any City Limits or ETJ.

Notes Corresponding to Schedule B:
10.c.) Easement, 169-391 - Does not appear to affect subject tract.

"The undersigned does hereby certify the following:

(i) This survey was this day made upon the ground of the property reflected hereon, for the benefit of and reliance upon by Carl W. Wilson and wife, Kaitia K. Wilson, as Seller, Steven U. Rath, Jr., as Purchaser, First American Title Insurance Company, as Title Company, and One SALS, Ltd., as Purchaser's lender;

(ii) The description contained herein is correct;

(iii) The land described herein together with all buildings and improvements thereon (the "Property") does not serve any adjoining property for drainage, utilities or ingress or egress;

(iv) This survey reflects boundary lines of the land, which "close" by engineering calculations;

(v) All utility services to the Property either enter the Property through adjoining public streets, or this survey shows the point of entry and location of any utilities which pass through or are located on adjoining private land to the extent visible or known to the undersigned;

(vi) The Property and only the Property constitutes one or more separate and complete tax lots;

(vii) The Property has access to and from a dedicated and accepted public thoroughfare;

(viii) Except as shown hereon, there are no discrepancies, conflicts, shortages in area, encroachments, improvements, overlapping of improvements, boundary line conflicts, set-back lines, easements, or roadways;

(ix) The gross area and net area shown hereon is correct;

(x) None of the Property lies within the 100 year flood plain or any special flood hazard area or general hazard area as designated by a governmental agency except as shown hereon;

(xi) There is no physical evidence of possession of the Property by any party other than the undersigned;

(xii) All zoning use and density classifications and all building restrictions and set-back lines are properly shown hereon."

February 28, 2014

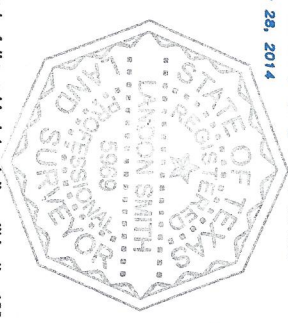

Landon Smith
R.P.L.S. No. 5969

Notes:

No part of the subject tract lies within the 100 year flood plain as soiled from F.I.R.M. Panel 48471C0150D, dated August 16, 2011.
Gross Area = 49.192 Acres
Net Area = 49.192 Acres

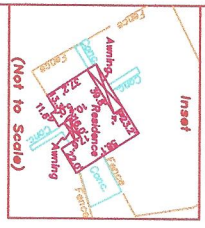

(Not to Scale)



CURVE	RADIUS	ARC LENGTH	CHORD LENGTH	CHORD BEARING	DELTA ANGLE
C1	1850.89'	300.44'	300.19'	N 69°42'44" W	08°47'00"

G.F. No.:

Field Notes Attached:

PREPARED FOR:

Steven U. Rath, Jr.

LAND TITLE SURVEY

49.192 ACRES
G. BADILLO GRANT, A-4
WALKER COUNTY, TEXAS

Trinity Woods Surveying (330) 738-5008
1088 Ray Anthony Road Huntsville, TX 77340
1088 Ray Anthony Road Huntsville, TX 77340
1088 Ray Anthony Road Huntsville, TX 77340

Piney Woods Surveying

1069 Fish Hatchery Road, Huntsville Texas 77340

DESCRIPTION

STATE OF TEXAS
COUNTY OF WALKER

49.192 ACRES

BEING all of that tract of land in Walker County, Texas, out of the G. Badillo Grant, A-4, and being all of that called 49.20 acres described in a deed to Carl Wilson as recorded in Volume 499, Page 520 of the Official Records of Walker County, Texas, and being further described as follows:

BEGINNING at a 3 inch pipe with a brass disk marked WK291 found at the North corner of said 49.20 acres and in the South line of that called 698 acres described in a deed to Trinity Timber L.P. as recorded in Volume 541, Page 168 of the Official Records of Walker County, Texas;

THENCE South 36 degrees 00 minutes 00 seconds East (Bearing Basis), 2466.61 feet to a 1/2 inch steel rod with a plastic cap marked 2005 found in the North line of said F.M. Highway No. 230 at the East corner of said 49.20 acres;

THENCE North 82 degrees 19 minutes 14 seconds West, 435.29 feet to a concrete highway monument found in the North line of said Highway at a point of curve;

THENCE Northwesterly 300.44 feet along a curve to the left having a radius of 1959.86 feet and a central angle of 08 degrees 47 minutes 00 seconds (Chord Bears North 86 degrees 42 minutes 44 seconds West, 300.15 feet) to a concrete highway monument found in the North line of said Highway;

THENCE South 88 degrees 53 minutes 46 seconds West, 632.60 feet to a 1/2 inch steel rod with a plastic cap marked 2005 found in the North line of said F.M. Highway No. 230 at the Southwest corner of said 49.20 acres;

THENCE North 35 degrees 58 minutes 30 seconds West, 1619.50 feet to a 1 inch pipe found at the West corner of said 49.20 acres, in the South line of said 698 acres;

THENCE North 54 degrees 17 minutes 40 seconds East, 1065.27 feet to the Point of Beginning, containing 49.192 acres of land.

The description shown hereon was prepared from an on-the-ground survey performed under my supervision during the month of February 2014.

February 28, 2014

Landon Smith
R.P.L.S. No. 5969



Plat Attached: Job Number 1402-017