

Listing #18351

Johnson County

9.26 ACRES
M/L

Premier BUILDING SITE AVAILABLE NEAR CORALVILLE LAKE

Peoples Company proudly presents a premier 9.26-acre buildable lot in Johnson County, Iowa, offering a rare combination of privacy, natural beauty, and convenience. Tucked at the end of a quiet dead-end road just south of Swisher, this stunning property is surrounded by mature timber and rolling hills, creating an ideal setting for a custom home, hobby farm, or peaceful retreat. The topography may support a walkout build with expansive second-story views overlooking the picturesque Iowa River corridor.

Outdoor enthusiasts will appreciate the abundant wildlife and recreational opportunities nearby. Whitetail deer, turkey, and other native species frequently roam the property, offering a true connection to nature right outside your door. Just minutes away, Coralville Lake and Lake Macbride State Park provide year-round enjoyment through hiking, boating, fishing, and wildlife observation, while the proximity to both Cedar Rapids and Iowa City ensures access to modern amenities, shopping, dining, and healthcare.

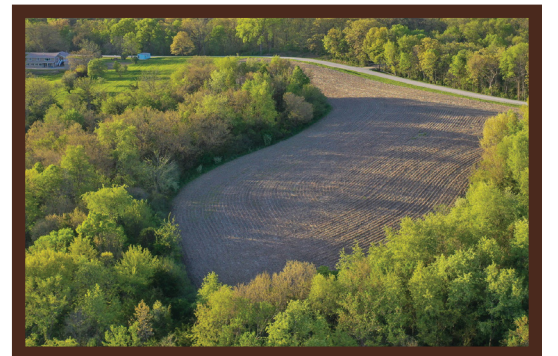
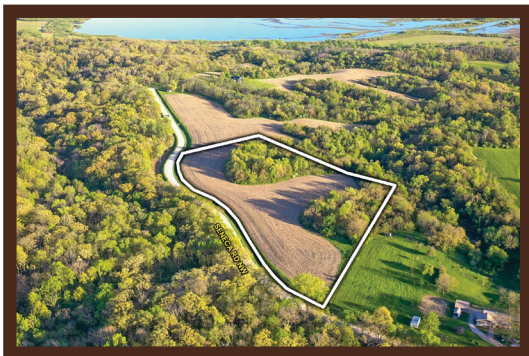

DISTANCE FROM:
Cedar Rapids: 20 Min
North Liberty: 18 Min
Downtown Iowa City: 30 Min
Curtis Bridge Boat Ramp: 13 Min



Located within the College Community School District and just 20 to 25 minutes from two major metro areas, this lot offers the perfect blend of rural tranquility and urban convenience. Very few buildable properties offer this much privacy and acreage on a secluded road in such a desirable location. Don't miss your chance to secure one of the last large, secluded lots in the heart of Eastern Iowa—an exceptional place to build now or invest in for the future.



Matt Hoenig
IA LIC S68835000 | 319.330.9735
Matt.Hoenig@PeoplesCompany.com



Riley Sieren
IA LIC S66739000 | 319.591.0111
Riley@PeoplesCompany.com



SHOWINGS WILL BE BY APPOINTMENT ONLY. PLEASE CONTACT MATT OR RILEY PRIOR TO WALKING THIS PROPERTY TO SCHEDULE AN APPOINTMENT.

All information, regardless of source, is deemed reliable but not guaranteed and should be independently verified. The information may not be used for any purpose other than to identify and analyze properties and services. The data contained herein is copyrighted by Peoples Company and is protected by all applicable copyright laws. Any dissemination of this information is in violation of copyright laws and is strictly prohibited.