

Soils Map

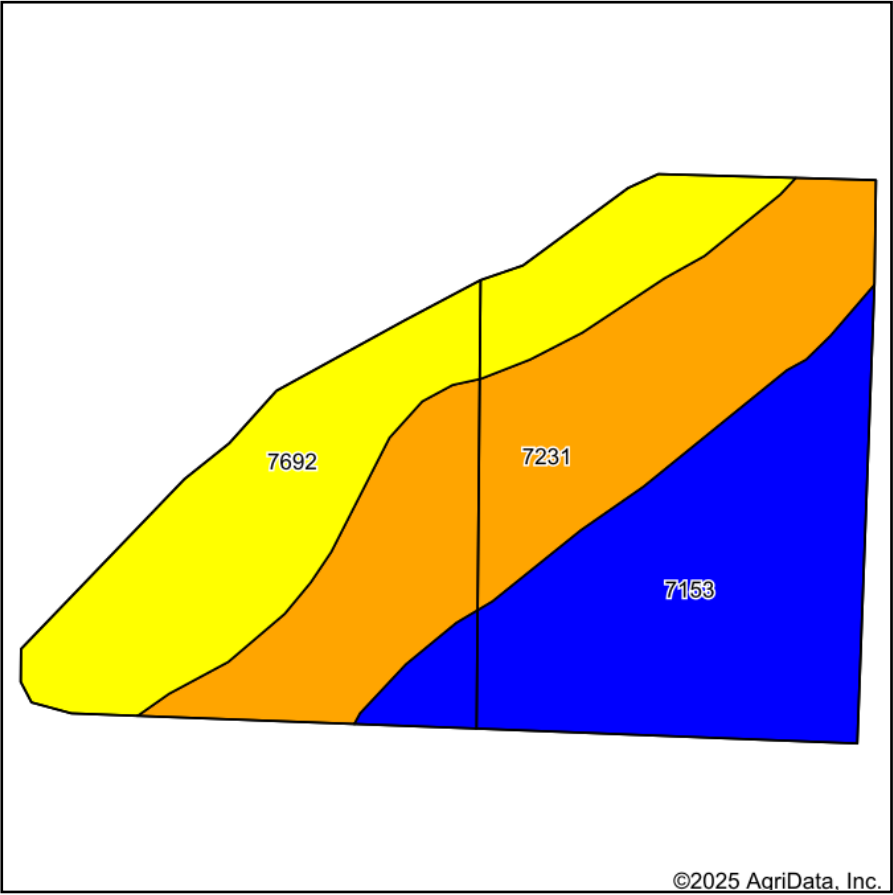

Soils data provided by USDA and NRCS.

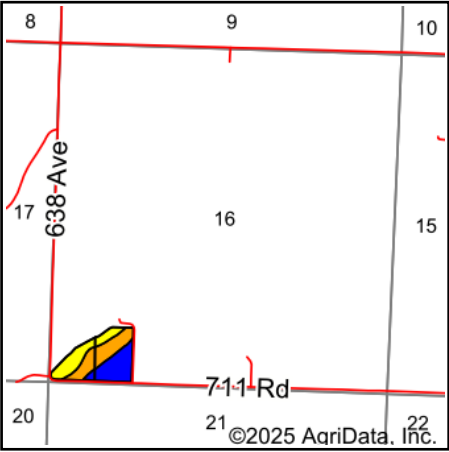

State: **Nebraska**
 County: **Richardson**
 Location: **16-2N-14E**
 Township: **Grant**
 Acres: **17.65**
 Date: **4/2/2025**



Area Symbol: NE147, Soil Area Version: 23								
Code	Soil Description	Acres	Percent of field	SRPG Legend	Non-Irr Class *c	Irr Class *c	SRPG	*n NCCPI Soybeans
7231	Judson silt loam, 2 to 6 percent slopes	6.40	36.2%		Ile		79	71
7153	Kennebec silt loam, rarely flooded	6.03	34.2%		Iw		83	84
7692	Wymore silty clay loam, 3 to 11 percent slopes, eroded	5.22	29.6%		IIle	IIle	70	51
Weighted Average					1.95	*-	77.7	*n 69.5

*n: The aggregation method is "Weighted Average using all components"
 *c: Using Capabilities Class Dominant Condition Aggregation Method
 *- Irr Class weighted average cannot be calculated on the current soils data due to missing data.