

# THE COMO INTERSTATE FARM

19<sup>±</sup> ACRES, WHITESIDE COUNTY, ILLINOIS



MARTIN, GOODRICH & WADDELL, INC.  
REAL ESTATE SERVICES

MGW.us.com  
info@mgw.us.com  
(815) 756-3606

Real Estate • Farm Management • Appraisals • Consulting



# THE COMO INTERSTATE FARM

## AERIAL MAP





# THE COMO INTERSTATE FARM

## HIGHWAY MAP

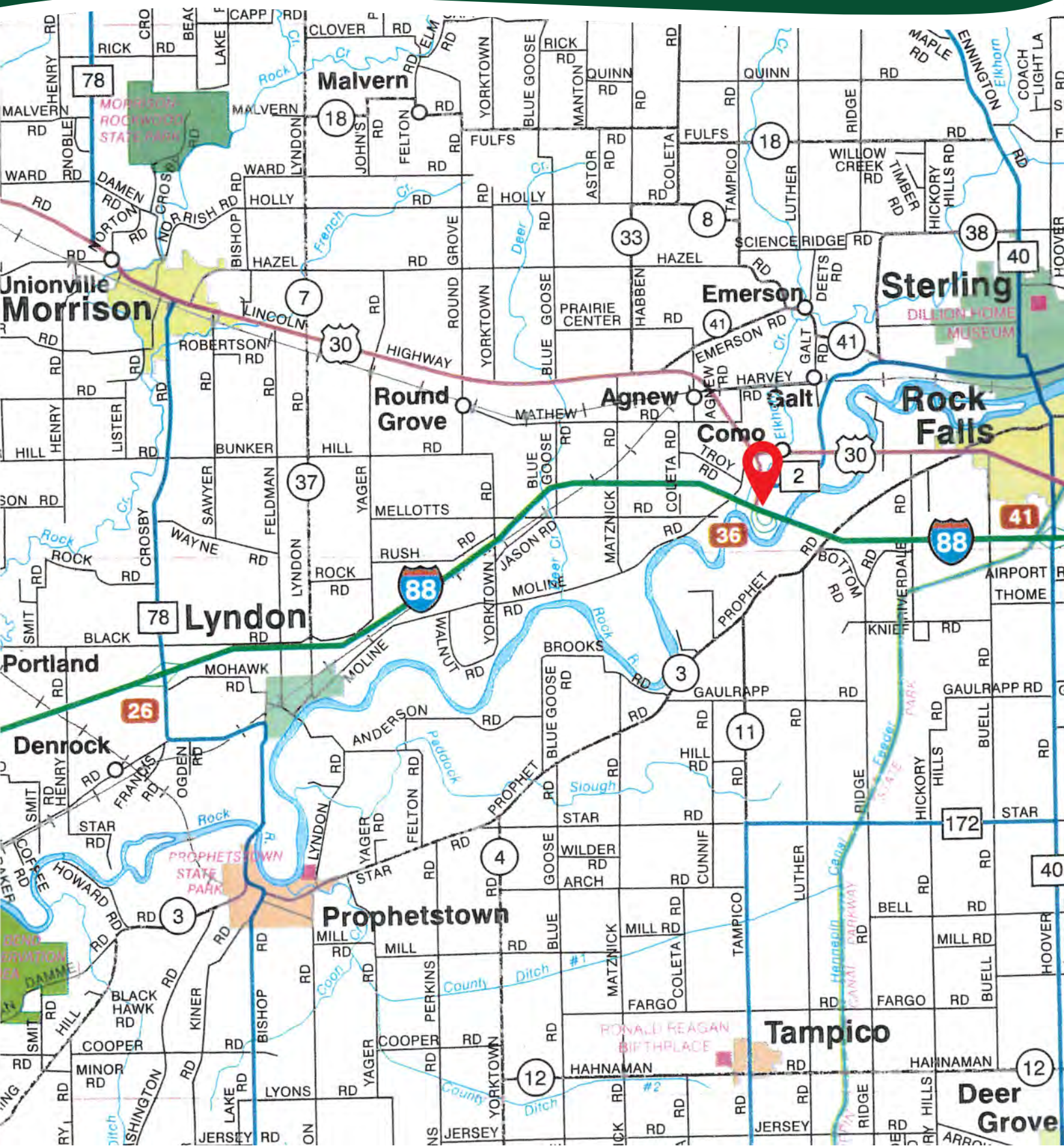

# THE COMO INTERSTATE FARM

## PROPERTY DETAILS

LOCATION	The subject farm is located approximately 97 miles west of Chicago O'Hare International Airport. Nearby cities include: Sterling (2 miles northeast), Rock Falls (3 3/8 miles east), and Morrison (8 5/8 miles northwest).
FRONTAGE	There is approximately 1/4 mile of road frontage on Interstate 88/Illinois Route 110, 1/8 mile on U.S. Route 30, and 1/16 mile on Como Road.
MAJOR HIGHWAYS	Interstate 88/Illinois Route 110 and U.S. Route 30 border the property and Illinois Route 40 is 4 1/2 miles east.
LEGAL DESCRIPTION	A brief legal description indicates The Como Interstate Farm is located in Part of the Southwest Quarter of Section 35, Township 21 North - Range 6 East (Hopkins Township), Whiteside County, Illinois.
TOTAL ACRES	There are a total of 19.41 acres, more or less, according to the Whiteside County Assessor.
TILLABLE ACRES	There are approximately 13 tillable acres according to the Whiteside County FSA.
SOIL TYPES	Major soil types found on this farm include Du Page silt loam and Ross silt loam.
TOPOGRAPHY	The topography of the subject farm is level.
MINERAL RIGHTS	All mineral rights owned by the seller will be transferred in their entirety to the new owner.
POSSESSION	Possession will be given at closing, subject to the terms and conditions set forth in a purchase contract.
PRICE & TERMS	The asking price is \$7,750 per acre. A 10% earnest money deposit should accompany any offer to purchase.
FINANCING	Mortgage financing is available from several sources. Names and addresses will be provided upon request.
GRAIN MARKETS	There are a number of grain markets located within 10 miles of The Como Interstate Farm.

# THE COMO INTERSTATE FARM

## PROPERTY DETAILS

TAXES	The 2024 real estate taxes totaled \$514.50. The tax parcel number is #10-35-300-009.
ZONING	The property is zoned A-1, Agricultural District.
COMMENTS	The information in this brochure is considered accurate, but not guaranteed. For inquiries, inspection appointments, and offers, please contact Bob Olson at Martin, Goodrich & Waddell, Inc. at 815-973-2700.



# THE COMO INTERSTATE FARM

## PROPERTY PHOTOS





# THE COMO INTERSTATE FARM

## PROPERTY PHOTOS





# THE COMO INTERSTATE FARM

## SOILS INFORMATION

### SOILS DESCRIPTIONS & PRODUCTIVITY DATA\*

SOIL #	SOIL NAME	APPROX. ACRES	PRODUCTIVITY INDEX (PI)
3321A	Du Page silt loam	7.17	113
7073A	Ross silt loam	4.66	137
802B	Orthents, loamy	0.77	0
727A	Waukee loam	0.40	109
WEIGHTED AVERAGE:			114.8

*\*Figures taken from the University of Illinois Bulletin 811, Optimum Crop Productivity Ratings for Illinois Soils.*



# THE COMO INTERSTATE FARM

## SOILS MAP

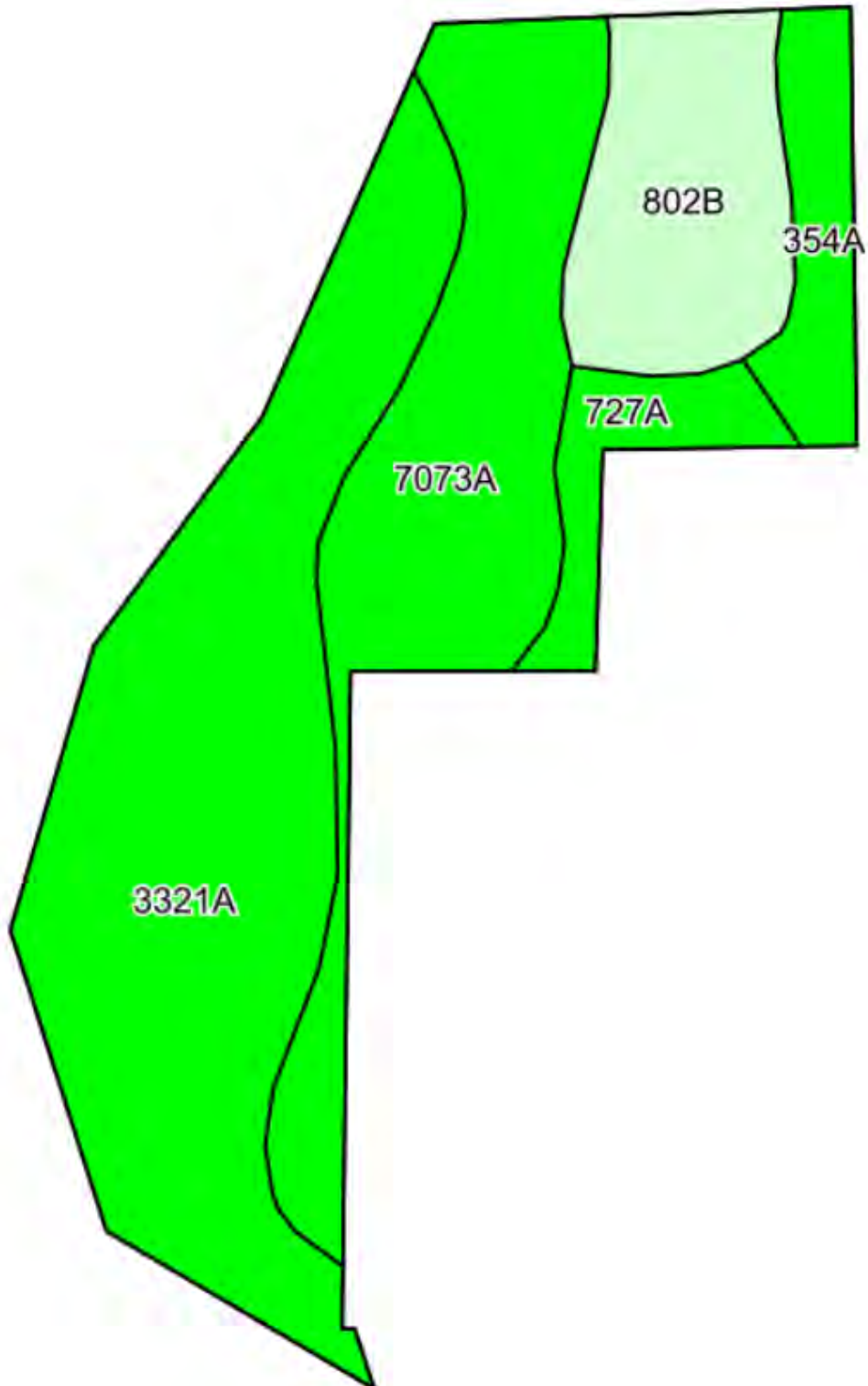



# PLAT MAP



# THE COMO INTERSTATE FARM

## APPENDIX

### THE FOLLOWING PAGES CONTAIN THESE DOCUMENTS:

1. FSA AERIAL MAP
2. FSA-156EZ
3. TOPOGRAPHY MAP
4. FLOODPLAIN MAP

For more information, please visit [MGW.us.com](http://MGW.us.com)

or contact:

Bob Olson (815) 973-2700 | [info@mgw.us.com](mailto:info@mgw.us.com)



MARTIN, GOODRICH & WADDELL, INC.  
REAL ESTATE SERVICES





United States  
Department of  
Agriculture

## Whiteside County, Illinois



### Legend

- Tract Boundary
- Non-Cropland
- Cropland
- CRP

### Wetland Determination Identifiers

- Restricted Use
- Limited Restrictions
- Exempt from Conservation Compliance Provisions

2024 Program Year

Map Created March 18, 2024

**Farm 9059**

**Tract 7041**

**Tract Cropland Total: 13.00 acres**

United States Department of Agriculture (USDA) Farm Service Agency (FSA) maps are for FSA Program administration only. This map does not represent a legal survey or reflect actual ownership; rather it depicts the information provided directly from the producer and/or National Agricultural Imagery Program (NAIP) Imagery. The producer accepts the data 'as is' and assumes all risks associated with its use. USDA-FSA assumes no responsibility for actual or consequential damage incurred as a result of any user's reliance on this data outside FSA Programs. Wetland Identifiers do not represent the size, shape, or specific determination of the area. Refer to your original determination (CPA-026 and attached maps) for exact boundaries and determinations or contact USDA Natural Resources Conservation Service (NRCS).



ILLINOIS  
WHITESIDE

Form: FSA-156EZ

See Page 2 for non-discriminatory Statements.



United States Department of Agriculture  
Farm Service Agency

Abbreviated 156 Farm Record

FARM : 9059

Prepared : 11/8/24 8:10 AM CST

Crop Year : 2025

Operator Name :  
CRP Contract Number(s) : None  
Recon ID : 17-195-2019-86  
Transferred From : None  
ARCPLC G/I/F Eligibility : Eligible

Farm Land Data

Farmland	Cropland	DCP Cropland	WBP	EWP	WRP	GRP	Sugarcane	Farm Status	Number Of Tracts
19.08	13.00	13.00	0.00	0.00	0.00	0.00	0.0	Active	1
State Conservation	Other Conservation	Effective DCP Cropland	Double Cropped			CRP	MPL	DCP Ag.Rel. Activity	SOD
0.00	0.00	13.00	0.00			0.00	0.00	0.00	0.00

Crop Election Choice

ARC Individual	ARC County	Price Loss Coverage
None	CORN, SOYBN	None

DCP Crop Data

Crop Name	Base Acres	CCC-505 CRP Reduction Acres	PLC Yield	HIP
Corn	12.41	0.00	147	0
Soybeans	0.59	0.00	46	0
<b>TOTAL</b>	<b>13.00</b>	<b>0.00</b>		

NOTES

Tract Number : 7041

Description : Hume T21N R6E Sec 35  
FSA Physical Location : ILLINOIS/WHITESIDE  
ANSI Physical Location : ILLINOIS/WHITESIDE  
BIA Unit Range Number :  
HEL Status : HEL determinations not completed for all fields on the tract  
Wetland Status : Wetland determinations not complete  
WL Violations : None  
Owners :  
Other Producers : None  
Recon ID : 17-195-2019-86

Tract Land Data

Farm Land	Cropland	DCP Cropland	WBP	EWP	WRP	GRP	Sugarcane
19.08	13.00	13.00	0.00	0.00	0.00	0.00	0.0

ILLINOIS  
WHITESIDE  
Form: FSA-156EZ



United States Department of Agriculture  
Farm Service Agency

Abbreviated 156 Farm Record

FARM : 9059  
Prepared : 11/8/24 8:10 AM CST  
Crop Year : 2025

Tract 7041 Continued ...

State Conservation	Other Conservation	Effective DCP Cropland	Double Cropped	CRP	MPL	DCP Ag. Rel Activity	SOD
0.00	0.00	13.00	0.00	0.00	0.00	0.00	0.00

DCP Crop Data

Crop Name	Base Acres	CCC-505 CRP Reduction Acres	PLC Yield
Corn	12.41	0.00	147
Soybeans	0.59	0.00	46
<b>TOTAL</b>	<b>13.00</b>	<b>0.00</b>	

NOTES

In accordance with Federal civil rights law and U.S. Department of Agriculture (USDA) civil rights regulations and policies, the USDA, its Agencies, offices, and employees, and institutions participating in or administering USDA programs are prohibited from discriminating based on race, color, national origin, religion, sex, gender identity (including gender expression), sexual orientation, disability, age, marital status, family/parental status, income derived from a public assistance program, political beliefs, or reprisal or retaliation for prior civil rights activity, in any program or activity conducted or funded by USDA (not all bases apply to all programs). Remedies and complaint filing deadlines vary by program or incident.

Persons with disabilities who require alternative means of communication for program information (e.g., Braille, large print, audiotape, American Sign Language, etc.) should contact the responsible Agency or USDA's TARGET Center at (202) 720-2600 (voice and TTY) or contact USDA through the Federal Relay Service at (800) 877-8339. Additionally, program information may be made available in languages other than English.

To file a program discrimination complaint, complete the USDA Program Discrimination Complaint Form, AD-3027, found online at [http://www.ascr.usda.gov/complaint\\_filing\\_cust.htm](http://www.ascr.usda.gov/complaint_filing_cust.htm) and at any USDA office or write a letter addressed to USDA and provide in the letter all of the information requested in the form. To request a copy of the complaint form, call (866) 632-9992. Submit your completed form or letter to USDA by: (1) mail: U.S. Department of Agriculture, Office of the Assistant Secretary for Civil Rights, 1400 Independence Avenue, SW, Washington, D.C. 20250-9410; (2) fax: (202) 690-7442; or (3) e-mail: [program.intake@usda.gov](mailto:program.intake@usda.gov). USDA is an equal opportunity provider, employer, and lender.



# TOPOGRAPHY MAP



©2024 AgriData, Inc.



Maps Provided By:



© AgriData, Inc. 2023 www.AgriDataInc.com

Source: USGS 1 meter dem

Interval(ft): 2.0

Min: 609.9

Max: 632.1

Range: 22.2

Average: 614.2

Standard Deviation: 4.1 ft

0ft 335ft 670ft



11/11/2024

35-21N-6E  
Whiteside County  
Illinois

Boundary Center: 41.761782, -89.779783



# FLOODPLAIN MAP



©2024 AgriData, Inc.



Boundary Center: 41.781782, -89.779783



**35-21N-6E**  
**Whiteside County**  
**Illinois**



Map Provided By:  
  
CUSTOMIZED ONLINE MAPPING  
© AgriData, Inc. 2023 [www.AgriDataInc.com](http://www.AgriDataInc.com)

11/11/2024

Flood related information provided by FEMA





MARTIN, GOODRICH & WADDELL, INC.  
REAL ESTATE SERVICES

Real Estate

Farm Management

Appraisals

Consulting



MGW.us.com  
Sycamore, IL 815-756-3606 • DeWitt, IA 563-659-6565  
info@mgw.us.com