

BOUNDARY LINE ADJUSTMENT

LOCATED IN SECTION 07, T. 22 N.,
R. 22 E., BOISE MERIDIAN, LEMHI COUNTY, IDAHO.

NARRATIVE

THE PURPOSE OF THIS SURVEY IS TO RELOCATE THE BOUNDARIES OF THE PARENT PARCEL IN LEMHI COUNTY, IDAHO. NO ADDITIONAL PARCELS ARE BEING CREATED THEREFORE, THIS SURVEY IS EXEMPT FROM LOT SPLIT REVIEW. THE BASIS OF BEARING FOR THIS SURVEY IS THE NE CORNER OF SECTION 07 AND THE N1/4 CORNER OF SECTION 07, WHICH BEARS N 89°54'58" W, 2643.51 FT.

THE FOLLOWING DOCUMENTS OF RECORD WERE REVIEWED AND CONSIDERED AS A PART OF THIS SURVEY. THERE MAY BE OTHER DOCUMENTS EITHER PRIVATE OR OF RECORD THAT WOULD AFFECT THIS SURVEY. ANY NEW EVIDENCE CONTRADICTORY TO THIS SURVEY SHOULD BE PRESENTED TO CIVIL SCIENCE FOR REVIEW AND CONSIDERATION.

LOT SPLIT PLAT, #243158, COMPLETED BY TAYLOR MOUNTAIN SURVEYING 2000
RECORD OF SURVEY, #300325, COMPLETED BY TAYLOR MOUNTAIN SURVEYING 2015

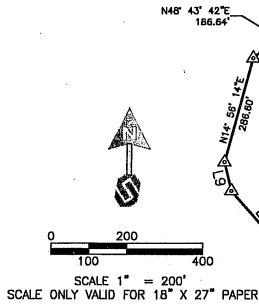

CERTIFICATE OF SURVEYOR

I DO HEREBY CERTIFY THAT I AM A PROFESSIONAL LAND SURVEYOR, LICENSED BY THE STATE OF IDAHO, AND THAT THIS MAP HAS BEEN PREPARED FROM AN ACTUAL SURVEY MADE ON THE GROUND UNDER MY DIRECT SUPERVISION, AND THAT THIS MAP IS AN ACCURATE REPRESENTATION OF SAID SURVEY, AND IS IN CONFORMITY WITH THE CORNER PERPETUATION AND FILING ACT, STATE OF IDAHO CODE 55-1601 THROUGH 55-1613 AND TO THE IDAHO CODE RELATING TO SURVEYS.



LEGEND

- PROPERTY BOUNDARY LINE.
- - - OLD PROPERTY BOUNDARY LINE.
- - - SECTION LINE
- - - QUARTER SECTION LINE
- - - RIGHT OF WAY LINE
- ⊕ ALUMINUM CAP
- ⊙ FOUND USFS BRASS CAP
- SET 5/8" REBAR WITH A PLASTIC CAP
- FOUND 1/2" REBAR WITH NO CAP
- ⊙ FOUND 1/2" REBAR WITH A PLASTIC CAP
- ⊙ FOUND 5/8" REBAR WITH AN ALUMINUM CAP
- △ CALC POINT
- POB POINT OF BEGINNING
- POL POINT ON LINE

NOTES

1. NO ATTEMPT HAS BEEN MADE AS A PART OF THIS BOUNDARY SURVEY TO OBTAIN OR SHOW DATA CONCERNING EXISTENCE, SIZE, DEPTH, CONDITION, CAPACITY, OR LOCATION OF ANY UTILITY OR MUNICIPAL/PUBLIC SERVICE FACILITY. FOR INFORMATION REGARDING THESE UTILITIES OR FACILITIES, PLEASE CONTACT THE APPROPRIATE AGENCIES OR OTHER.
2. SURVEYOR HAS MADE NO INVESTIGATION OR INDEPENDENT SEARCH FOR EASEMENTS OF RECORD, ENCUMBRANCES, RESTRICTIVE COVENANTS, OWNERSHIP, TITLE EVIDENCE, OR ANY OTHER FACTS WHICH AN ACCURATE AND CURRENT TITLE SEARCH MAY DISCLOSE.

PARCEL A
CONTAINS 31.32 ACRES +/-
ZERO SPLITS REMAIN

PARCEL B
CONTAINS 96.44 ACRES +/-
THREE SPLITS REMAIN
91.09

CURVE TABLE

CURVE #	LENGTH	RADIUS	TANGENT	DELTA	CHORD BEARING	CHORD LENGTH
C1	707.36'	11409.78'	353.79'	3°33'08"	S5°41'08"W	707.24'
C2	327.89'	11409.78'	163.95'	1°38'47"	S8°17'06"W	327.87'

LINE TABLE

LINE #	DIRECTION	LENGTH
L1	N4°24'53"W	125.09'
L2	S10°00'36"W	93.62'
L3	N0°21'18"E	243.56'
L4	N64°11'31"W	162.60'
L5	N37°35'04"W	107.30'
L6	N72°22'40"W	229.89'
L7	N66°58'46"W	205.23'
L8	N41°09'57"W	223.70'
L9	N13°38'24"W	79.20'
L10	N1°51'44"E	113.98'
L11	N4°49'43"E	34.80'
L12	N89°54'58"W	182.00'

*minus 5 acres
w/ 30' Easement*



BOUNDARY LINE ADJUSTMENT

STICE

LOCATED IN
TOWNSHIP 22 NORTH, RANGE 22 EAST
BOISE MERIDIAN, LEMHI COUNTY, IDAHO

FILE: STICE BOUNDARY ADJUSTMENT
CSI PROJ #: 23089.00
DRAWN BY: JH
DESIGN BY: KH
CHECKED BY: MB
ONE INCH
AT FULL SIZE, IF NOT ONE
INCH, SCALE ACCORDINGLY
LAST UPDATED: 5/30/2023
SHEET NUMBER:

LEGEND

- PROPERTY BOUNDARY LINE
- SECTION LINE
- QUARTER SECTION LINE
- R/W RIGHT OF WAY LINE
- ALUMINUM CAP
- FOUND USFS BRASS CAP
- SET 5/8" REBAR WITH A PLASTIC CAP
- FOUND 1/2" REBAR WITH NO CAP
- FOUND 1/2" REBAR WITH A PLASTIC CAP
- FOUND 5/8" REBAR WITH ALUMINUM CAP
- CALCULATED POINT/NOTHING SET
- POC POINT OF COMMENCEMENT
- POB POINT OF BEGINNING
- POL POINT ON LINE

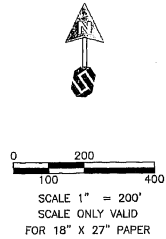

SURVEYORS CERTIFICATE:

I, MITCH BARRERAS, A REGISTERED PROFESSIONAL LAND SURVEYOR IN THE STATE OF IDAHO DO HEREBY CERTIFY THAT THIS PLAT IS AN ACCURATE REPRESENTATION OF THE SURVEY COMPLETED UNDER MY SUPERVISION, AND IS IN CONFORMITY WITH THE CORNER PERPETUATION AND FILING ACT, STATE OF IDAHO, CODE 55-1601 THROUGH 55-1613 AND TO THE IDAHO CODE RELATING TO SURVEYS.



Instrument # 333516
LENGH COUNTY, Idaho
Oct 30, 2023 3:44:56 pm Feet S 50.00
Eva CIVIL SCIENCE
BRENDA ARMSTRONG, Recorder
CMORSE, Deputy

Pages: 2

NOTES

- NO ATTEMPT HAS BEEN MADE AS A PART OF THIS BOUNDARY SURVEY TO OBTAIN OR SHOW DATA CONCERNING EXISTENCE, SIZE, DEPTH, CONDITION, CAPACITY, OR LOCATION OF ANY UTILITY OR MUNICIPAL/PUBLIC SERVICE FACILITY. FOR INFORMATION REGARDING THESE UTILITIES OR FACILITIES, PLEASE CONTACT THE APPROPRIATE AGENCIES OR OTHER.
- SURVEYOR HAS MADE NO INVESTIGATION OR INDEPENDENT SEARCH FOR EASEMENTS OF RECORD, ENCUMBRANCES, RESTRICTIVE COVENANTS, OWNERSHIP, TITLE EVIDENCE, OR ANY OTHER FACTS WHICH AN ACCURATE AND CURRENT TITLE SEARCH MAY DISCLOSE.

LOT SPLIT PLAT

LOCATED IN SECTION 07, T. 22 N.,
R. 22 E., BOISE MERIDIAN; LEMHI COUNTY, IDAHO.

APPROXIMATE LOCATION OF
FEMA 160092 0415B

BASIS OF BEARING
S89°55'00"E 2843.50'

CURVE #	LENGTH	RADIUS	TANGENT	DELTA	CHORD BEARING	CHORD LENGTH
C2	327.89'	11409.78'	163.95'	1°38'47"	S8°17'06"W	327.87'

PARCEL B
CONTAINS 91.09 ACRES +/-
TWO SPLITS REMAIN

NARRATIVE

THE BASIS OF BEARING FOR THIS LOT SPLIT IS THE N1/4 CORNER OF SECTION 07 AND THE NE CORNER OF SECTION 07, WHICH BEARS S 89°55'00" E, 2843.50 FT.

THE FOLLOWING DOCUMENTS OF RECORD WERE REVIEWED AND CONSIDERED AS A PART OF THIS SURVEY. THERE MAY BE OTHER DOCUMENTS EITHER PRIVATE OR OF RECORD THAT WOULD AFFECT THIS SURVEY. ANY NEW EVIDENCE CONTRADICTORY TO THIS SURVEY SHOULD BE PRESENTED TO CIVIL SCIENCE FOR REVIEW AND CONSIDERATION.

LOT SPLIT PLAT, #243148, COMPLETED BY TAYLOR MOUNTAIN SURVEYING 2000
RECORD OF SURVEY, #300326, COMPLETED BY TAYLOR MOUNTAIN SURVEYING 2015
BOUNDARY LINE ADJUSTMENT PLAT, #252276, COMPLETED BY CIVIL SCIENCE 2023

LINE #	DIRECTION	LENGTH
L1	N10°00'36"E	93.62'
L2	S0°21'18"W	243.58'
L3	N64°11'31"W	162.80'
L4	N37°35'04"W	107.30'
L5	N72°22'40"W	229.89'
L6	N66°58'46"W	205.23'
L7	N41°09'57"W	223.70'
L8	N13°38'24"W	79.20'
L9	N1°51'44"E	113.98'
L10	N4°49'43"E	34.80'

SEC 7 C.P.F. #242717



CivilScience
376 FALLS AVENUE
TWIN FALLS, ID 83301
208.737.0007

LOT SPLIT PLAT
STICE

LOCATED IN N1/2 SECTION 07
TOWNSHIP 22 NORTH, RANGE 22 EAST
BOISE MERIDIAN, LEMHI COUNTY, IDAHO

FILE: STICE LOT SPLIT
CSI PROJ # : 23080-00
DRAWN BY: KSH
DESIGN BY: KSH
CHECKED BY: MB
DATE: 10-19-23
AT FULL SIZE, IF NOT ONE
INCH, SCALE ACCORDINGLY
LAST UPDATED: 10/19/2023
SHEET NUMBER:
2 OF 2

8K 14 PG 31