

MAPTECH MAP

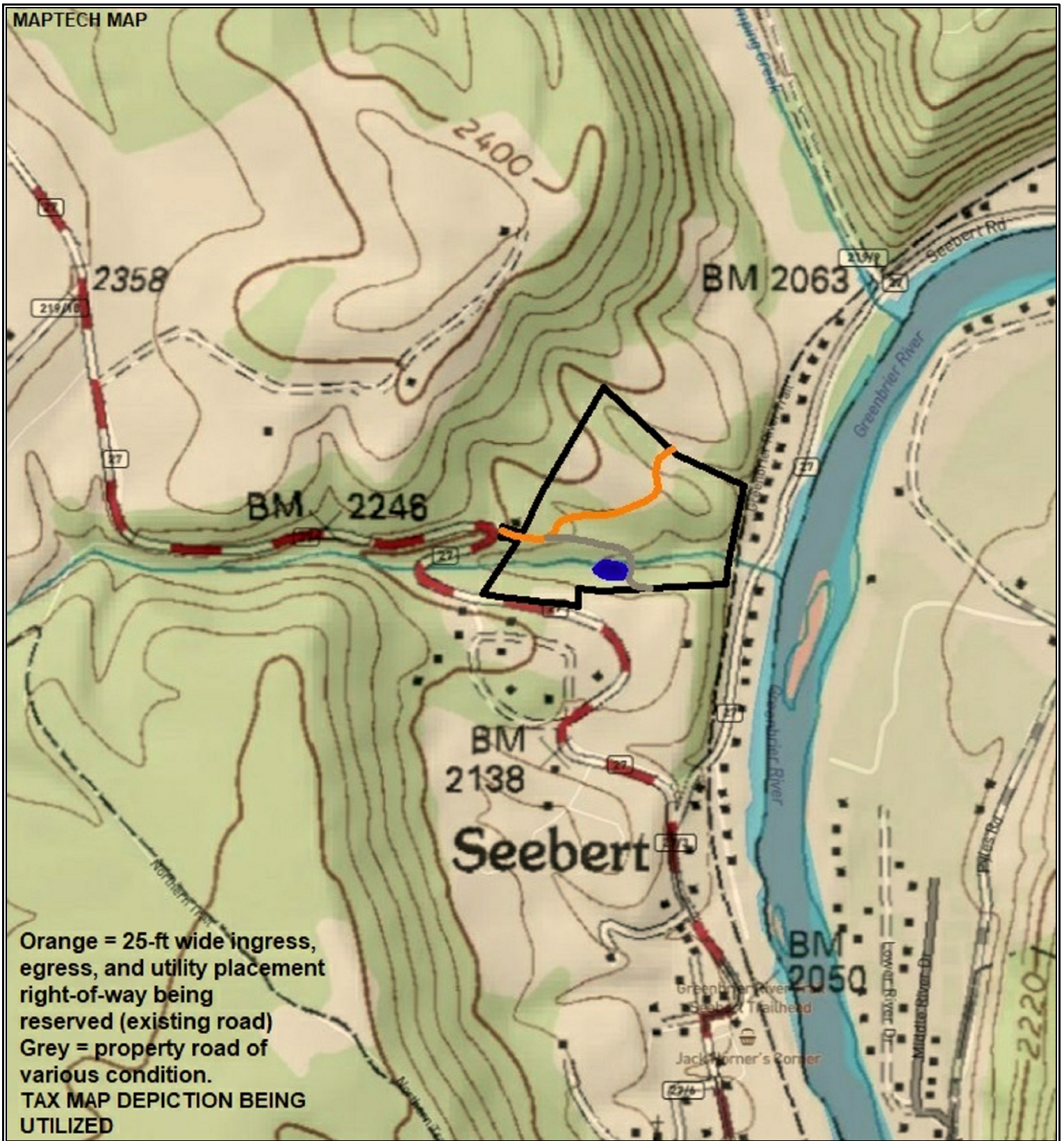

OL' PEACHEY PLACE
Pocahontas County, WV
TOPOGRAPHIC MAP
Elevation Range: 2091' - 2216' +/-
Google Coordinates:
LAT 38.135185 (N), LON -80.180615 (W)
This map is for general location purposes only.
Consult a licensed land surveyor for actual
boundary location and acreage.
TAX PARCELS DEPICTION IS UTILIZED.

FOXFIRE
REALTY

RICHARD GRIST, Broker - Auctioneer - Forester
304.645.7674 Richard@Foxfirenation.com
WWW.FOXFIRENATION.COM